

REVISION RECORD				
NO	DATE	FROM	TO	BY

FIELD ATTACHMENT FOR AIR COOLED CONDENSER TUBING

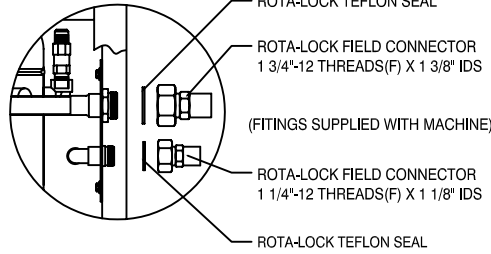

10" MINIMUM CLEARANCE BEHIND UNIT FOR CONDENSER LINE ACCESS

40" MINIMUM FOR WATER TANK ACCESS

9 1/2" CONDENSER LINE CONNECTION

12" MINIMUM CLEARANCE FOR INSTALLATION AND ACCESS

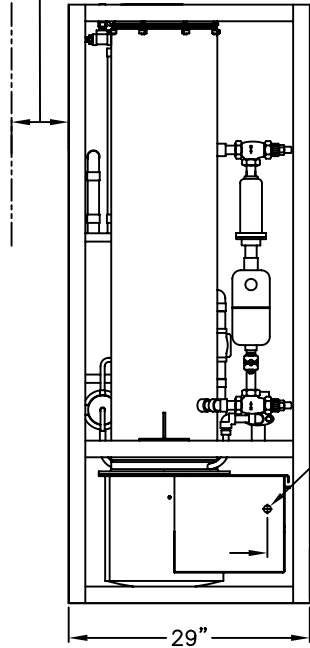

LEFT

3/4" FPT WATER TANK DRAIN CONNECTION (LOCATED ON THE BACK OF UNIT)

1/2" MPT MAKE-UP WATER CONNECTION

11 3/8"

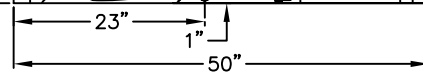

FRONT

36" MINIMUM FOR CONTROL PANEL ACCESS

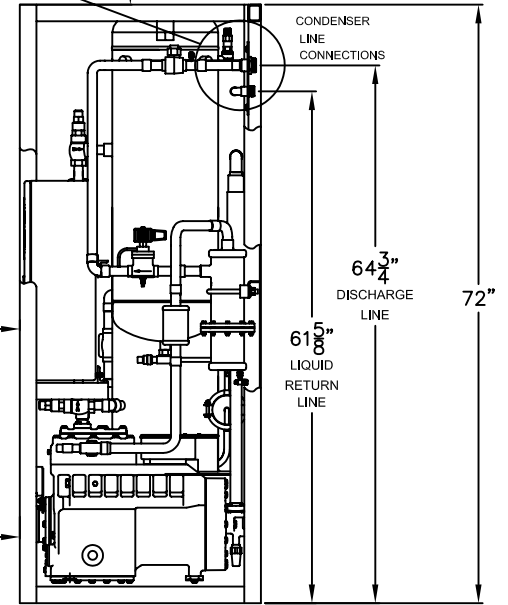

RIGHT

40" MINIMUM FOR COMPRESSOR ACCESS

MINIMUM BIN OPENING - 6 1/2" x 6 1/2"
 MAXIMUM BIN OPENING - 7" x 7"
 CHUTE SIZE - 5 5/8" X 5 5/8"

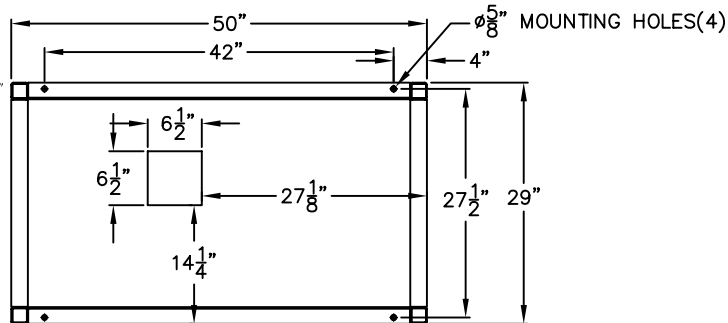

ICE CHUTE LOCATION/MACHINE FOOTPRINT

This drawing contains TUBE ICE, LLC confidential and proprietary information and cannot be used, duplicated or disclosed in whole or in part, except with the express written permission of TUBE ICE, LLC.

Except as expressly stated in any written contract, ALL WARRANTIES RELATING TO THIS DRAWING, INCLUDING THE WARRANTIES OF MERCHANTABILITY AND FITNESS, ARE DISCLAIMED.

© 2004 TUBE ICE, LLC all rights reserved or an unpublished work.

DWN. BY Mirek Radzaj

CKD. BY _____

RLSD. BY _____

DATE 6/8/05

SCALE N/A

TUBE ICE, LLC
 1000 W. ORMSBY AVE., LOUISVILLE, KY, 40210

SPACE DIAGRAM AND CONNECTIONS FOR AIR COOLED 03TA ICE MACHINE

PART NO. _____

DRG. NO. 81734