



The HES Series with a capacity range of 3000 to 4000 pounds of ice per day is the preferred choice of ice machine for thousands of food service applications worldwide.

Heavy-duty industrial construction, automatic operation, energy efficiency and the best warranty in the business make the Vogt HES Series the only "clear" choice for your ice making needs.

HES Standard Features:

- ★ 25 Year Evaporator Warranty
- ★ Voltage - 208/230v.,3p.,60hz.
- ★ Refrigerant 452a
- ★ Cutter for cylinder (default) or crushed ice operation
- ★ Copeland Performance Alert power monitor
- ★ Electronic ice bin thermostat
- ★ Stainless steel casings
- ★ Integral drip pan
- ★ Self-Diagnostic indicator light
- ★ Water-cooled or remote air-cooled operation
- ★ PLC Controls

HES Tube-Ice Available in Two Ice Sizes:

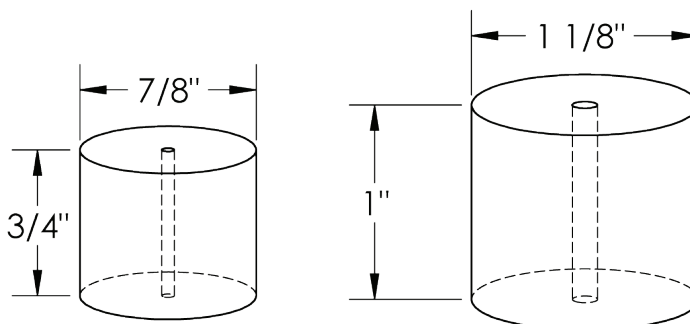

HES Series Options:

- ★ Voltage - 460v.,3p.,60hz.
- ★ Voltage - 400v.,3p.,50hz.
- ★ Voltage - 200v.,3p.,50hz.
- ★ High ambient air-cooled condenser
- ★ Electro-fin coated condenser
- ★ High pressure (200psig) water condenser/regulator
- ★ Casing security screws (Correctional usage)
- ★ Cutter for 1-1/2" long ice
- ★ Remote switch box
- ★ Flush valve assembly
- ★ "CE" Approval (400v, 50hz only)
- ★ Canadian Registration Number (CRN)
- ★ Export crating (ISPM-15 Rated)

Energy usage based on makeup water temperature of 70 ° F. (21 ° C.), ambient (air) temperature of 90 ° F. (32 ° C.).

Capacity rating is average for the model.

Individual machines may vary +/- 5%.

Capacity based on ambient (air) temperature of 90 ° F. (32 ° C.).

Capacity reduced 17% for 50hz. operation.

Makeup water usage includes 20% blowdown.

| Model | Machine Capacity | | | | | | Water Usage | | | | Energy Usage | |
|---------|---------------------|------|-------------|------|--------------|------|-------------|---------------|------------|---------------|---------------|------------|
| | Make-Up Temperature | | | | | | Ice Making | | Condenser | | (KWH/100 lbs) | |
| | 50°F (10°C) | | 70°F (21°C) | | 90°F (32 °C) | | Gal/100lbs | Liters/100lbs | Gal/100lbs | Liters/100lbs | Water Cooled | Air Cooled |
| HES-30S | 3070 | 1393 | 2750 | 1247 | 2300 | 1043 | 14.5 | 54.9 | 220 | 833 | 3.32 | 4.11 |
| HES-30M | 2690 | 1220 | 2400 | 1089 | 2010 | 912 | | | 341 | 1291 | 3.63 | 4.82 |
| HES-40S | 4070 | 1846 | 3620 | 1642 | 3230 | 1465 | | | 171 | 647 | 3.38 | 4.24 |
| HES-40M | 3565 | 1617 | 3170 | 1438 | 2830 | 1284 | | | 402 | 1522 | 3.80 | 4.85 |

Vogt Ice LLC

1000 W. Ormsby Avenue

Louisville, KY 40210

(800) 853-8648, (502) 635-3000

info@vogtice.com



www.vogtice.com



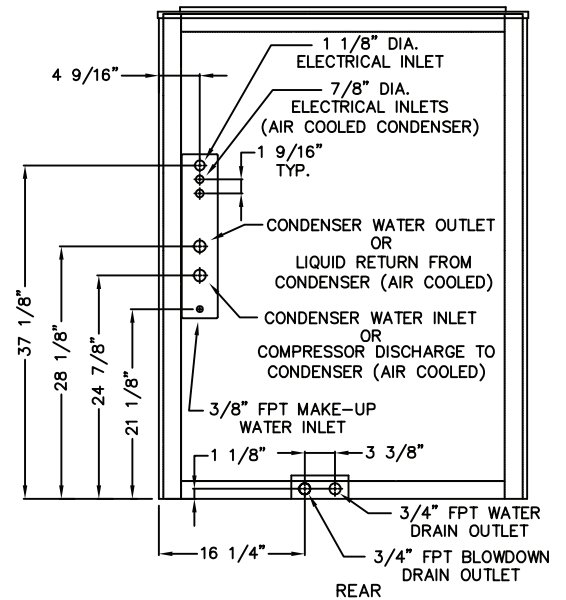
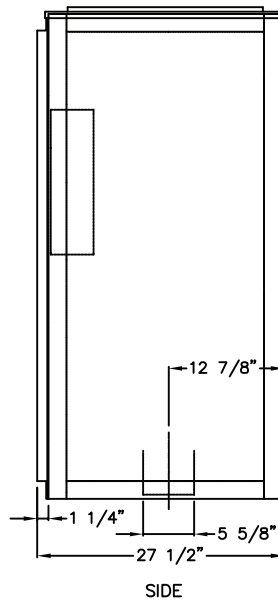
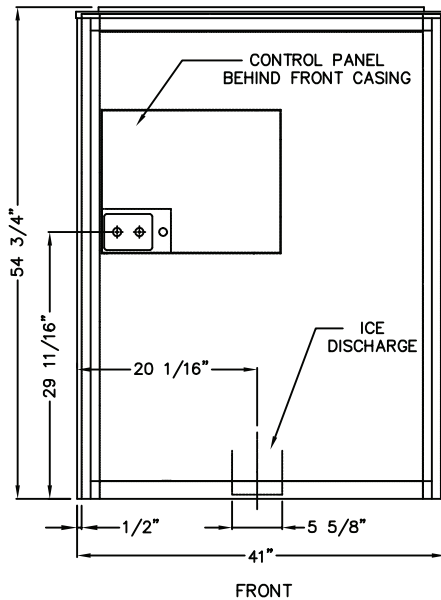

NOTE: MACHINE FOOTPRINT WITHOUT CASINGS: 40" X 26" X 54"

| | | Ice Machine Electrical Information | | | | | | Motor Information | | | | Shipping Weight | |
|--------|---------------------|------------------------------------|---------------|-----------------------|------------|---------------|------------------|-------------------|--------------|------------------------|------------|-----------------|-----|
| | | Water Cooled | | | Air Cooled | | | Water Pump | Cutter Motor | Condenser Fan Motor(s) | Compressor | | |
| Model | Voltage | F.L.A. | Min. Ampacity | Max. Fuse Size (Amps) | F.L.A. | Min. Ampacity | Max. Fuse (Amps) | H.P. | | | | Lbs | Kg |
| HES-30 | 208/230V, 3ph, 60hz | 21.6 | 25.4 | 45 | 29.6 | 33.4 | 50 | 1/3 | 1/2 | 2@1/2 | 4 | 1250 | 567 |
| | 460V, 3ph, 60hz | 10.7 | 12.6 | 20 | 11.6 | 13.5 | 20 | | | | | | |
| | 200V, 3ph, 50hz | 22.6 | 26.4 | 40 | 30.6 | 34.4 | 45 | | | | | | |
| | 400V, 3ph, 50hz | 11.2 | 13.1 | 20 | 12.1 | 14.9 | 20 | | | | | | |
| HES-40 | 208/230V, 3ph, 60hz | 27.3 | 32.5 | 55 | 35.3 | 40.5 | 65 | 1/3 | 1/2 | 2@1/2 | 6 | 1275 | 578 |
| | 460V, 3ph, 60hz | 14.8 | 17.7 | 25 | 15.7 | 19.5 | 30 | | | | | | |
| | 200V, 3ph, 50hz | 28.3 | 33.5 | 50 | 36.3 | 41.5 | 60 | | | | | | |
| | 400V, 3ph, 50hz | 15.3 | 18.2 | 25 | 16.2 | 20.0 | 30 | | | | | | |

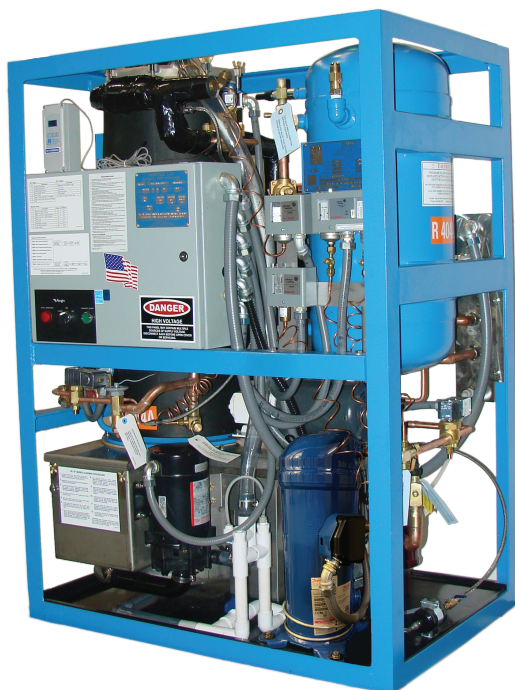

| Line Size Connections | | |
|------------------------------------|----------|----------|
| Ice Making Water | | 3/8" FPT |
| Drain Connections | Overflow | 3/4" FPT |
| | Drip Pan | 3/4" FPT |
| * Condenser Water Inlet and Outlet | HES-30 | 3/4" FPT |
| | HES-40 | 1" FPT |

** See service manual or air-cooled installation instruction packet for sizing discharge and return piping.

NOTE: * WATER COOLED MACHINE / ** AIR COOLED MACHINE

Operating Conditions

The ice machine shall not be subjected to an atmospheric temperature lower than 50 ° F. (10 ° C.) nor higher than 90 ° F. (32 ° C.) without effect on performance. Water for condensing or ice making purposes shall be non-corrosive.

The water shall be at a constant pressure no less than 30lbs. at the ice machine location. The condition of the water to make satisfactory ice shall be the responsibility of the purchaser.